

FORM NO. 1.

Courses up Juniata -  
Post 556 E 11  
569 E 76  
584 E 46  
N 85 E 3 1/2 Post  
164 1/2

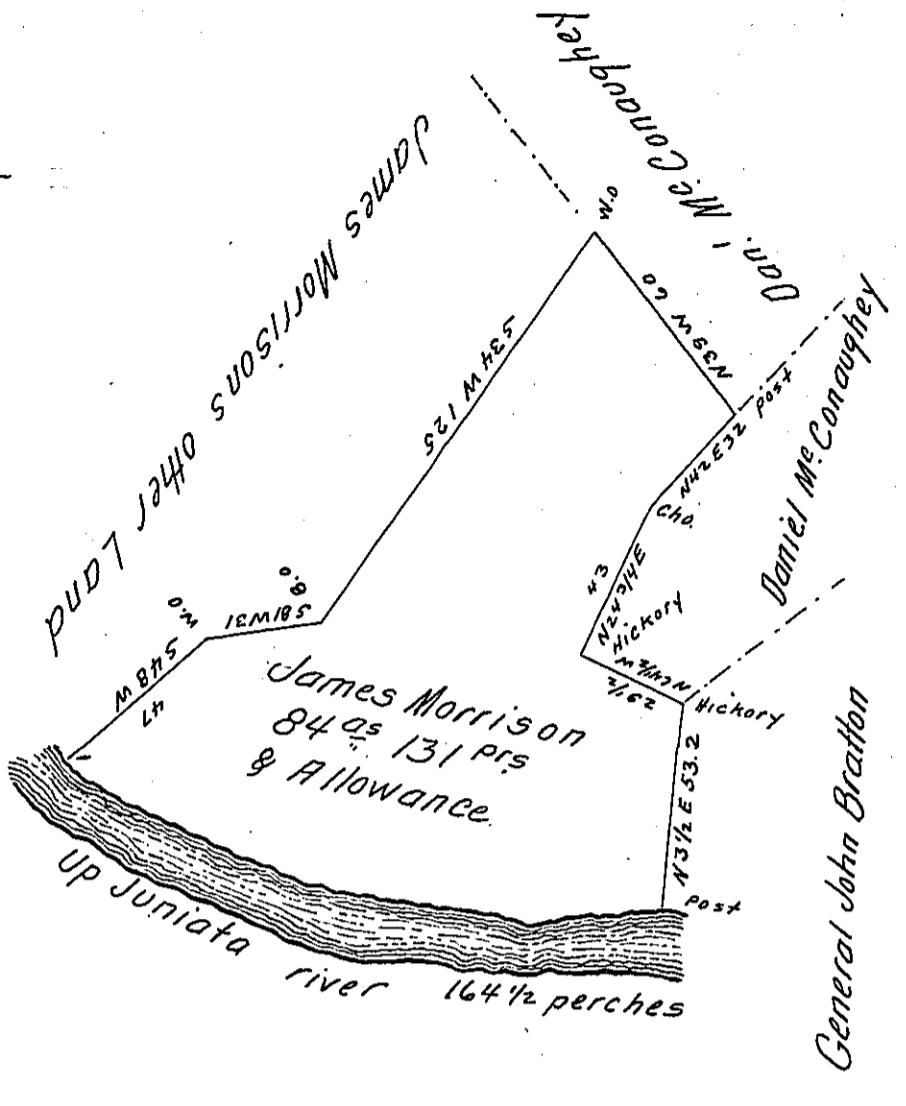

Situate in Shirley township Huntingdon County. Containing Eighty four acres 131 perches and allowance. Surveyed Nov<sup>r</sup> 6<sup>th</sup> 1813 in pursuance of a warrant Granted to James Morrison dated October 19<sup>th</sup> 1813.

Note. Grain has been raised on the above Land. there is a house thereon with a family Residing therein.

Richard T. Leech Esqr. }  
Surveyor General }      Jn<sup>r</sup> Morrison D.S.

Now Wayne Township Mifflin County

IN TESTIMONY that the above is a copy of the original remaining on file in the Department of Internal Affairs of Pennsylvania, made conformably to an Act of Assembly approved the 16th day of February, 1833, I have hereunto set my Hand and caused the Seal of said Department to be affixed at Harrisburg, this twenty sixth day of April 1906.

*Lucas B. Brown*  
Secretary of Internal Affairs.